

- GENERAL NOTES:
- 1) All earthworks to be in accordance with Greater Wellington Regional Councils guidance on "Small Earthworks Erosion and Sediment Control for Small Sites."
 - 2) Works is to proceed in a small steps with areas of open ground being closed and completed including aggregate/topsoil/plantings or impervious ground cover before breaking new ground.
 - 3) The maximum area of open ground shall not excede 2000m2 at any one time, and shall be open for typically less than a month.
 - 4) Ponds and associated discharge structures shall be sized, built and operated in accordance with www.hbrc.govt.nz/HBRC-Documents/.../Erosion_Pt6A.pdf (or or any other appropriate standard directed by the engineer)
 - 5) Stage 3 subdivision works are not to start until approval of further silt management detail relating to the works on lots 5,6, 7 and 8.

Legend

Lot boundaries	Silt fence	Stormwater catchment area
Existing title boundaries	Clear water	Silt pond
contours original	Discharge	Bund/channel

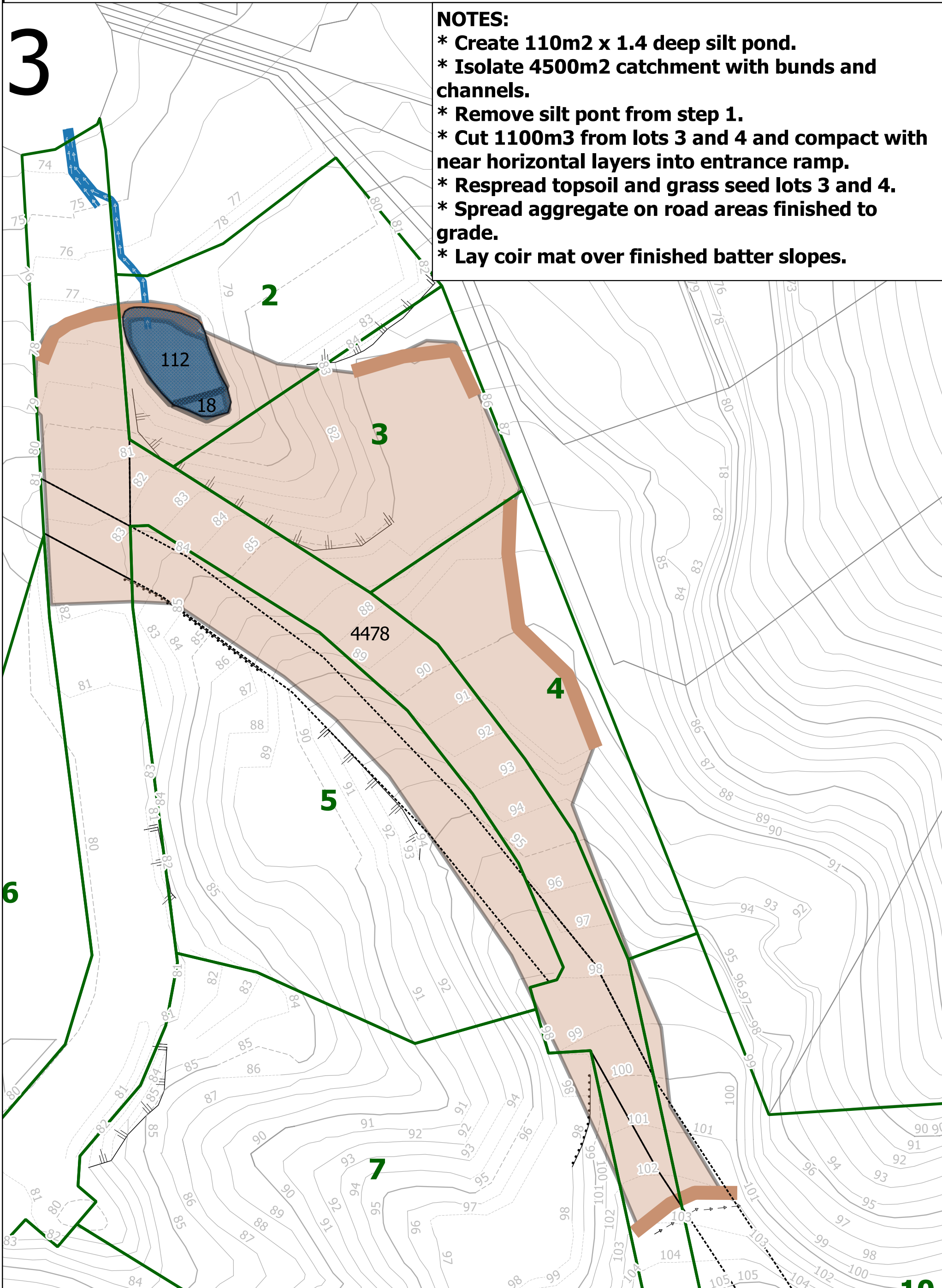
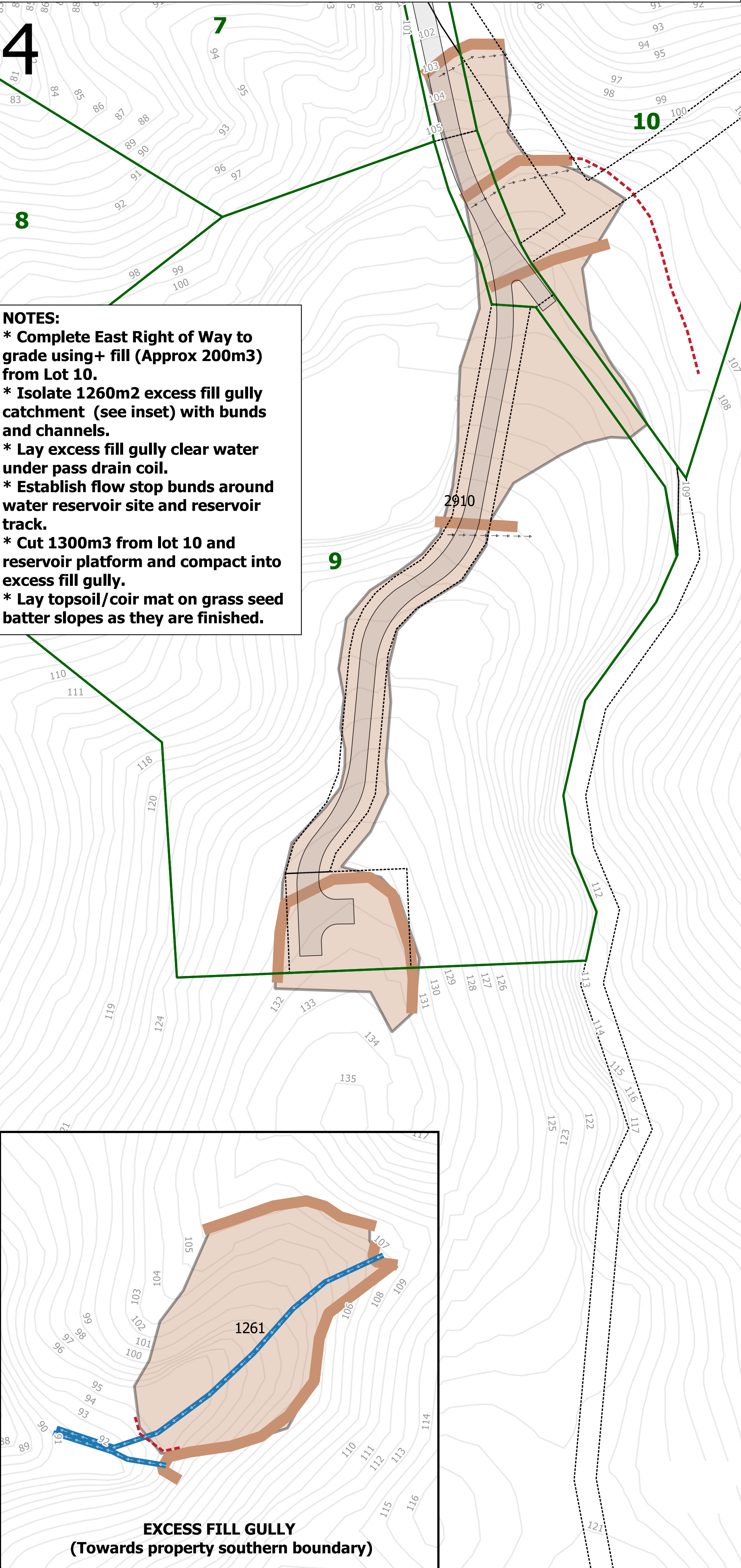
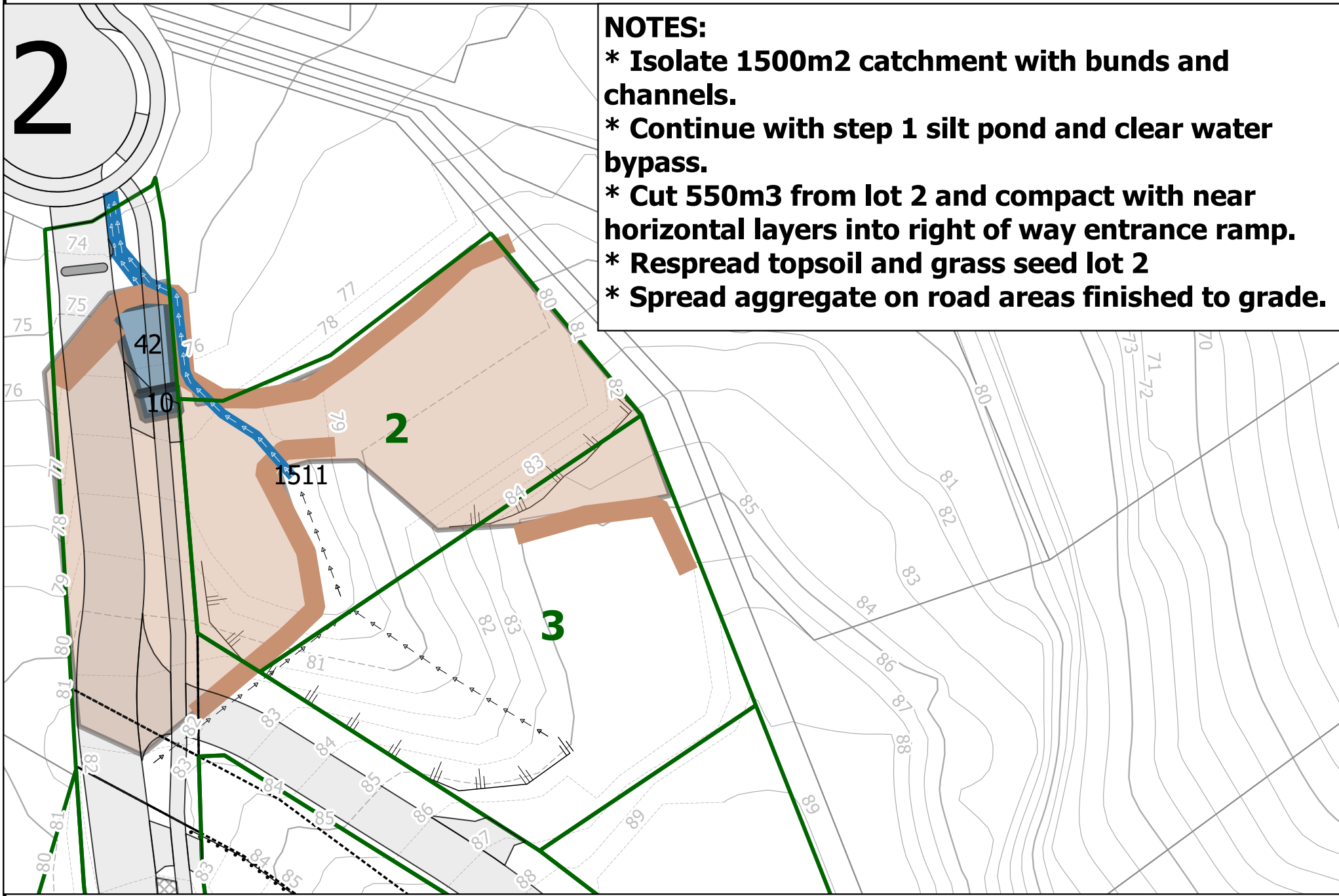

<div><div>Progeni Ltd</div><div>68 Exploration Way, Porirua 5024 Ph 64 022 0819600</div></div>	Client: Progeni Ltd	Fieldwork: -	-	Scale:1:100 at A1; 1:200 at A3
	Project: Exploration Heights RC6601	Designed: Harpham(Progeni)	03/15	ID: P1.ENG044.1 Rev:2016-01-27
	Title: Silt management	Drawn: Harpham(Progeni)	01/16	Issued by: David Harpham
		Checked:		Date: 2016-01-27