

- NOTES:**
- * Isolate 1334m² catchment with bunds and channels.
 - * Establish clear water bypass discharge pipe.
 - * Create 42m² silt pond x 1.4m deep.
 - * Cut 250m³ from lot 1 and compact with near horizontal layers into right of way entrance ramp.
 - * Respread topsoil and grass seed lot 1
 - * Spread aggregate on road areas finished to grade.

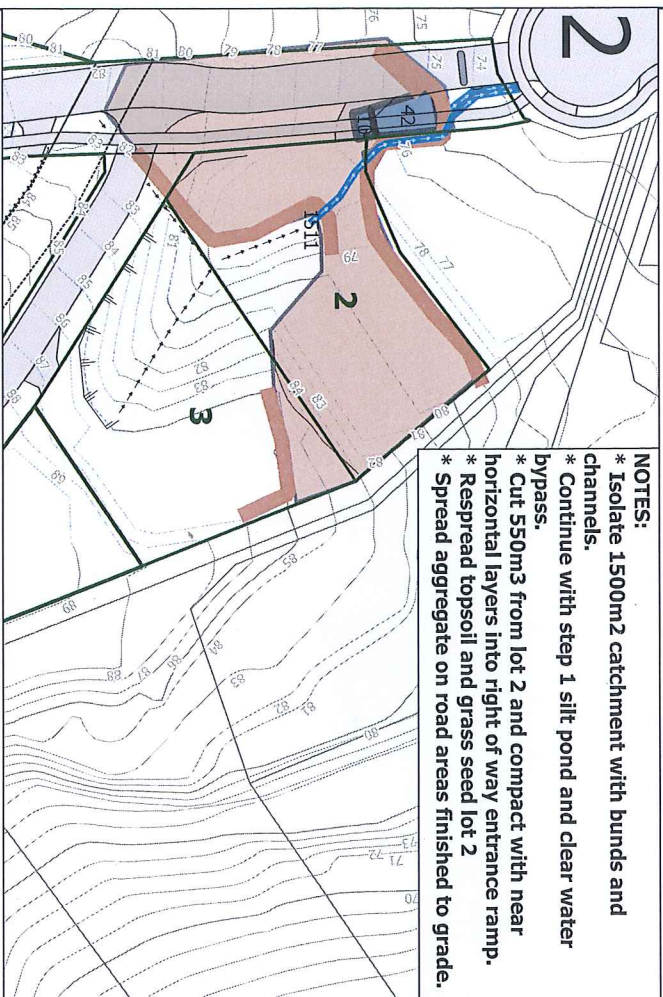

- NOTES:**
- * Isolate 1500m² catchment with bunds and channels.
 - * Continue with step 1 silt pond and clear water bypass.
 - * Cut 550m³ from lot 2 and compact with near horizontal layers into right of way entrance ramp.
 - * Respread topsoil and grass seed lot 2
 - * Spread aggregate on road areas finished to grade.

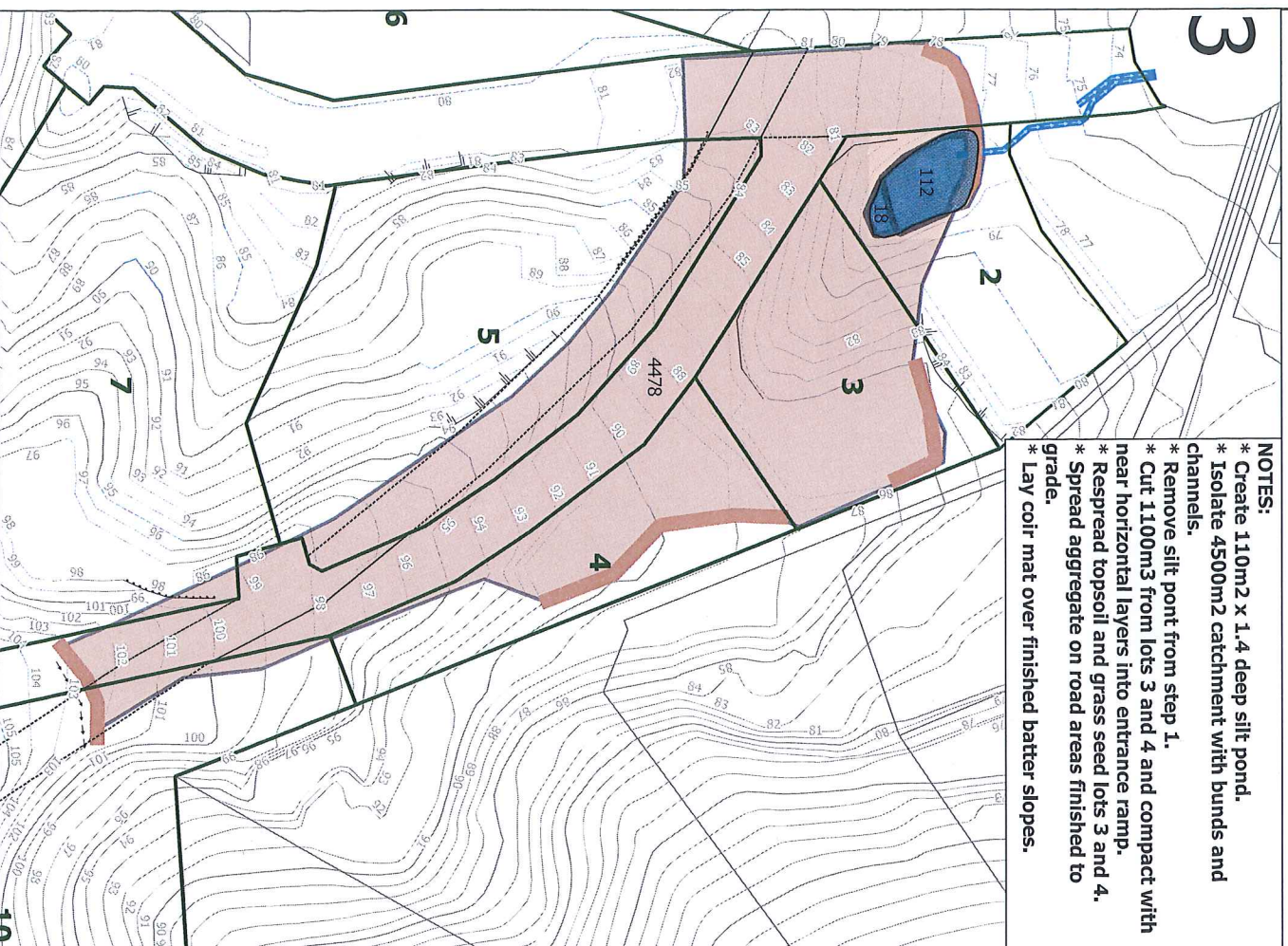

- NOTES:**
- * Create 110m² x 1.4 deep silt pond.
 - * Isolate 4500m² catchment with bunds and channels.
 - * Remove silt point from step 1.
 - * Cut 1100m³ from lots 3 and 4 and compact with near horizontal layers into entrance ramp.
 - * Respread topsoil and grass seed lots 3 and 4.
 - * Spread aggregate on road areas finished to grade.
 - * Lay coir mat over finished batter slopes.

- GENERAL NOTES:**
- 1) All earthworks to be in accordance with Greater Wellington Regional Councils guidance on "Small Earthworks Erosion and Sediment Control for Small Sites."
 - 2) Works is to proceed in a small steps with areas of open ground being closed and completed including aggregate/topsoil/plantings or impervious ground cover before breaking new ground.
 - 3) The maximum area of open ground shall not exceed 2000m² at any one time, and shall be open for typically less than a month.
 - 4) Ponds and associated discharge structures shall be sized, built and operated in accordance with www.hbrc.govt.nz/HBRC-Documents/.../Erosion_Pt6A.pdf (or or any other appropriate standard directed by the engineer)
 - 5) Stage 3 subdivision works are not to start until approval of further silt management detail relating to the works on lots 5,6, 7 and 8.

- Legend**
- ☐ Lot boundaries
 - ☐ Existing title boundaries
 - ☒ Contours original
 - ☒ Silt fence
 - ☒ Clear water
 - ☒ Stormwater catchment area
 - ☒ Silt pond
 - ☒ Bund/channel

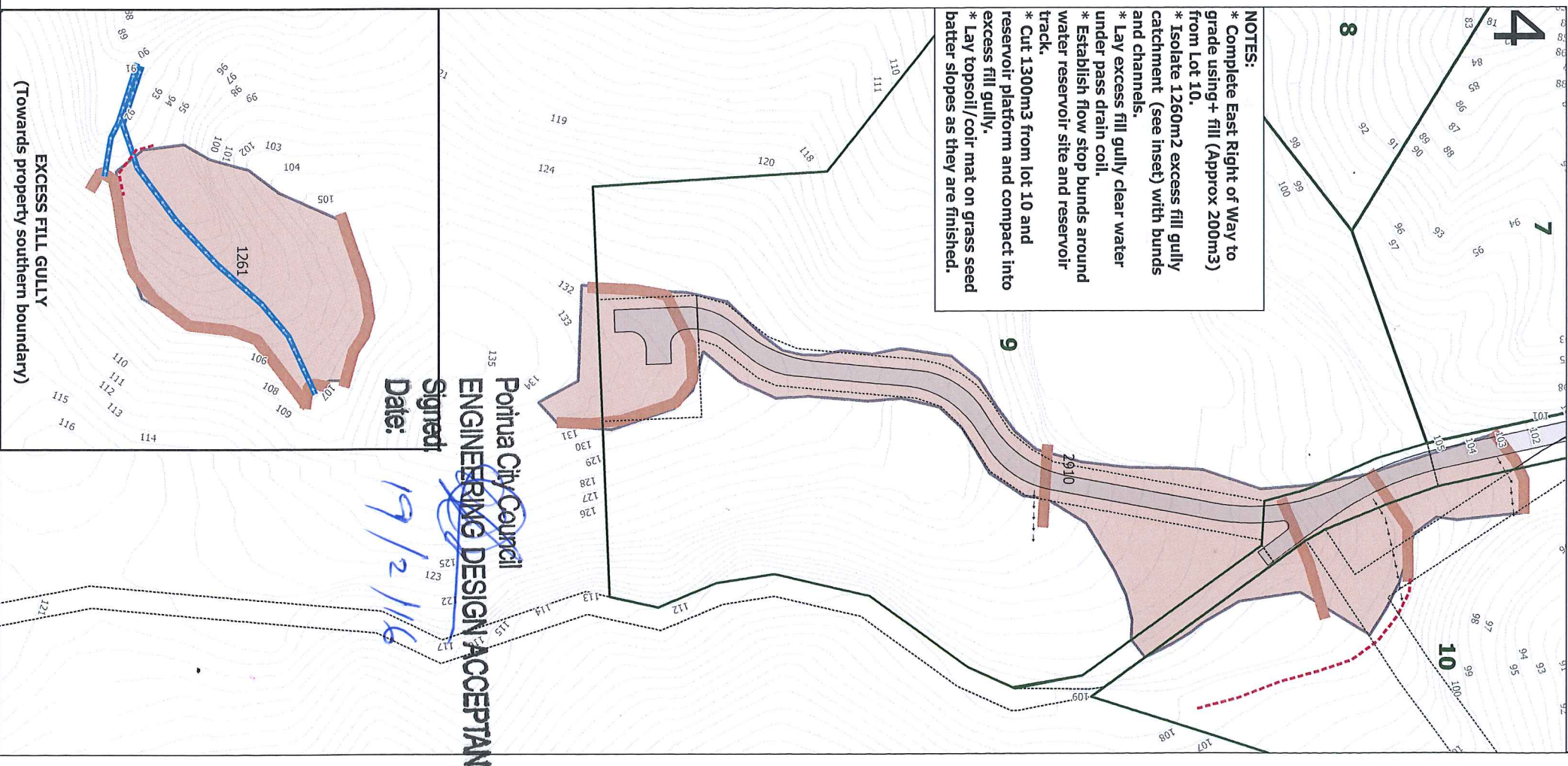

- NOTES:**
- * Complete East Right of Way to grade using + fill (Approx 200m³) from Lot 10.
 - * Isolate 1260m² excess fill gully catchment (see inset) with bunds and channels.
 - * Lay excess fill gully clear water under pass drain coil.
 - * Establish flow stop bunds around water reservoir site and reservoir track.
 - * Cut 1300m³ from lot 10 and reservoir platform and compact into excess fill gully.
 - * Lay topsoil/coir mat on grass seed batter slopes as they are finished.

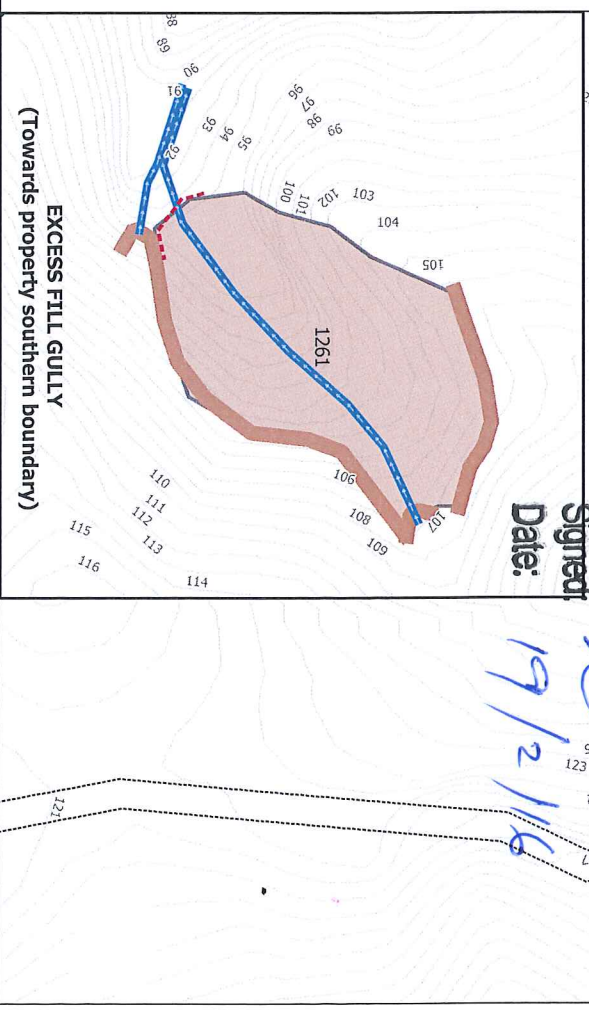

Portua City Council
ENGINEERING DESIGN ACCEPTANCE
Signed: [Signature]
Date: 19/12/16

EXCESS FILL GULLY
(Towards property southern boundary)

Fieldwork:-	-	Scale:1:100 at A1, 1:200 at A3
Designed: Harpham(Progeni)	03/15	ID: P1.ENG044.1 Rev:2016-01-27
Drawn: Harpham(Progeni)	01/16	Issued by: David Harpham
Checked:		Date: 2016-01-27

Progeni Ltd
68 Exploration Way, Porirua 5024
Ph 64 022 0819600

Client: Progeni Ltd
Project: Exploration Heights RC6601
Title: Silt management